



長野計器

圧力計用ジョイント

FJ10形



JIS油圧図記号

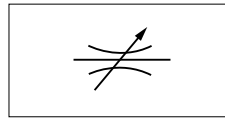

材 質：黄銅製（生地）
鉄製（NIメッキ）
ステンレス製（生地）

仕 様

FJ10-□□□
メス-オスジョイント

形番			d ₁ × d ₂ (メス) (オス)	A	E	F	B×C 六角
黄銅製	鉄製	ステンレス製					
FJ10-231	FJ10-232	FJ10-233	G1/4×G3/8B	36	14	18	19×21.9
-241	-242	-243	G1/4×G1/2B	38		20	22×25.4
-321	-322	-323	G3/8×G1/4B	36	16	16	22×25.4
-331	-332	-333	G3/8×G3/8B	40		20	22×25.4
-421	-422	-423	G1/2×G1/4B	38	18	16	27×31.2
-431	-432	-433	G1/2×G3/8B	40		18	27×31.2
FJ10-271	FJ10-272	FJ10-273	G1/4×R1/4	34		16	19×21.9
-281	-282	-283	G1/4×R3/8	36	14	18	19×21.9
-291	-292	-293	G1/4×R1/2	38		20	22×25.4
-371	-372	-373	G3/8×R1/4	36		16	22×25.4
-381	-382	-383	G3/8×R3/8	38	16	18	22×25.4
-391	-392	-393	G3/8×R1/2	40		20	22×25.4
-471	-472	-473	G1/2×R1/4	38		16	27×31.2
-481	-482	-483	G1/2×R3/8	40	18	18	27×31.2
-491	-492	-493	G1/2×R1/2	42		20	27×31.2
FJ10-731	FJ10-732	FJ10-733	Rc1/4×G3/8B	36	12	18	19×21.9
-741	-742	-743	Rc1/4×G1/2B	38		20	22×25.4
-831	-832	-833	Rc3/8×G3/8B	38		18	22×25.4
-841	-842	-843	Rc3/8×G1/2B	40	14	20	22×25.4
-931	-932	-933	Rc1/2×G3/8B	40		18	27×31.2
-941	-942	-943	Rc1/2×G1/2B	42	17	20	27×31.2
FJ10-2B1	FJ10-2B2	FJ10-2B3	G1/4×1/4NPT	34		16	19×21.9
-2C1	-2C2	-2C3	G1/4×3/8NPT	36	14	18	19×21.9
-2D1	-2D2	-2D3	G1/4×1/2NPT	38		20	22×25.4
-3B1	-3B2	-3B3	G3/8×1/4NPT	36		16	22×25.4
-3C1	-3C2	-3C3	G3/8×3/8NPT	38	16	18	22×25.4
-3D1	-3D2	-3D3	G3/8×1/2NPT	40		20	22×25.4
-4B1	-4B2	-4B3	G1/2×1/4NPT	38		16	27×31.2
-4C1	-4C2	-4C3	G1/2×3/8NPT	40	18	18	27×31.2
-4D1	-4D2	-4D3	G1/2×1/2NPT	42		20	27×31.2

外形寸法

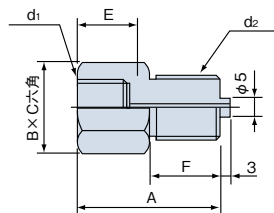
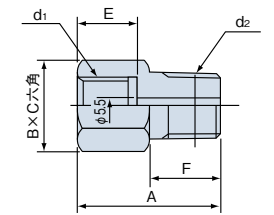
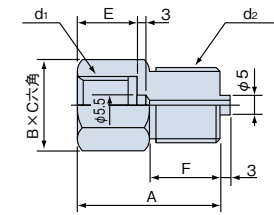
FJ11-□□□
メス-メスジョイント

形番			d ₁ × d ₂ (メス) (メス)	A	E	F	B×C 六角
黄銅製	鉄製	ステンレス製					
FJ11-2B1	FJ11-2B2	FJ11-2B3	G1/4×1/4NPT	33		12	19×21.9
-2C1	-2C2	-2C3	G1/4×3/8NPT	38	14	14	22×25.4
-2D1	-2D2	-2D3	G1/4×1/2NPT	42		17	27×31.2
-3B1	-3B2	-3B3	G3/8×1/4NPT	38		12	22×25.4
-3C1	-3C2	-3C3	G3/8×3/8NPT	38	16	14	22×25.4
-3D1	-3D2	-3D3	G3/8×1/2NPT	42		17	27×31.2
-4B1	-4B2	-4B3	G1/2×1/4NPT	42		12	27×31.2
-4C1	-4C2	-4C3	G1/2×3/8NPT	42	18	14	27×31.2
-4D1	-4D2	-4D3	G1/2×1/2NPT	42		17	27×31.2
FJ11-771	FJ11-772	FJ11-773	Rc1/4×Rc1/4	32		12	19×21.9
-781	-782	-783	Rc1/4×Rc3/8	34	12	14	22×25.4
-791	-792	-793	Rc1/4×Rc1/2	37		17	27×31.2
-881	-882	-883	Rc3/8×Rc3/8	36	14	14	22×25.4
-891	-892	-893	Rc3/8×Rc1/2	39		17	27×31.2
-991	-992	-993	Rc1/2×Rc1/2	42	17	17	27×31.2

